

DS-19A08-01BN(G)

MBUS Security Control Panel

DS-19A08-01BN(G) is MBUS Security Control Panel with 8 inputs onboard and expandable to 256. It supports uploading reports to multiple alarm centers with various transmission modes such as PSTN, network and GPRS. The report content and uploading method can be configured through client operation and keypad programming. The control panel is mainly applied to various industries such as finance, judicature, education, transport, electricity as well as shopping malls, stores, residences, apartments, communities and so on.



AVAILABLE MODEL

Model	Description
DS-19A08-01BN	8 inputs onboard and expandable to 256, PSTN+LAN
DS-19A08-01BNG	8 inputs onboard and expandable to 256, PSTN+LAN+GPRS

MAIN FEATURES

- 8 inputs onboard and expandable to 256
- 4 outputs onboard and expandable to 256
- 2 buses, up to 2.4km each (RVV2*1.5mm)
- Tree and hand in hand bus topology are available
- MBUS non-polarity
- Transmission method: PSTN+LAN+(GPRS)
- Each transmission method can upload alarm information to two different alarm receiving center(ARC)
- Supports SMS alarm, alarm elimination, arm, disarm (-G)
- Remotely search event logs
- Remotely upgrade
- Remotely configure for importing/exporting
- Support 1 installer code, 1 master code and 199 operator code
- Contact ID protocol, up to 250 CID reports and telephone line multiplex
- Supports 32 keypads and 32 keyfobs
- Supports accumulator for power supply
- Scheduled arming/disarming function
- 8 partitions, including 1 public partition
- Tampering alarm for the control panel and detector
- Supports 1-ch siren output
- Up to 8000 alarm event logs, 2000 operation event logs and 1500 user

- management event can be stored
- Relay output programmable
- 1-ch of 12V/1A auxiliary power output
- Support hardware reset

TYPICAL APPLICATION

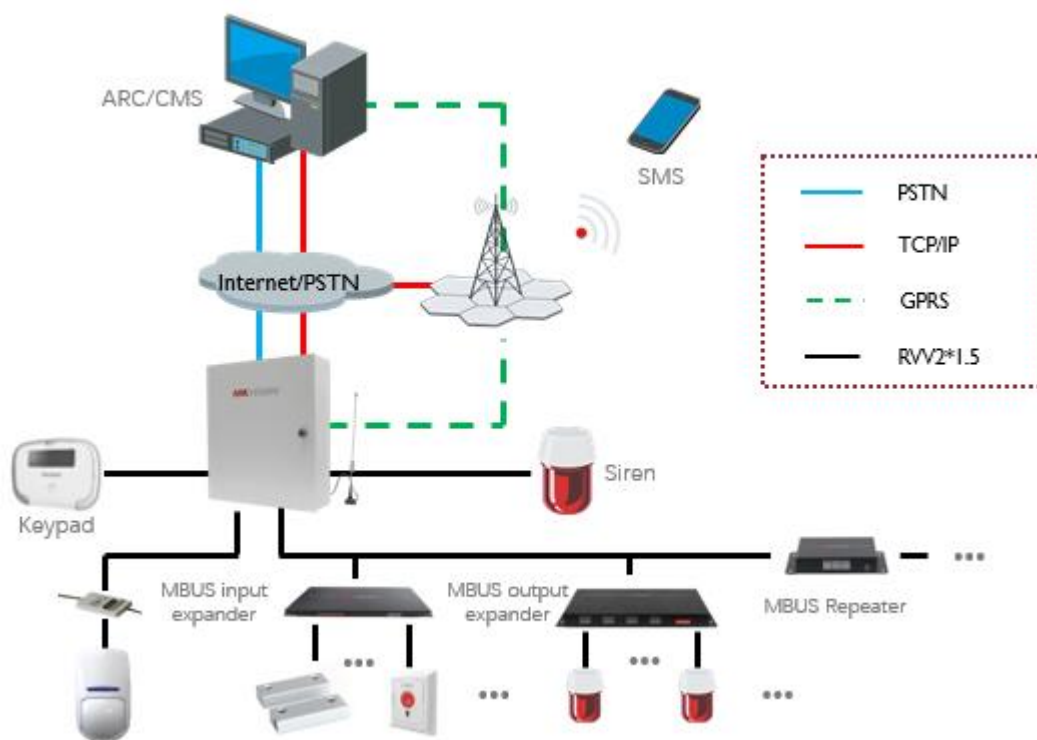

SPECIFICATION

Model		DS-19A08-01BN	DS-19A08-01BNG
Security Control Panel Parameters	Alarm Input	8 inputs onboard expandable to 256	
	Alarm Output	4 outputs onboard and expandable to 256 (Capacity:30VDC/1A)	
	Scheduled Output Rule	YES	
	Siren Power Supply	12 VDC /750 mA	
	PSTN	Support (1-ch)	
	Auxiliary Power Output	12 VDC/1 A	
	Supported Keypads (LCD)	32	
	Tamper-proof Switch	1, Support Tampering Alarm	
	Scheduled Arming/Disarming	Support (Normal Schedule/Preferential Schedule)	
	Partitions	8 Partitions, 1 Public Partition	
	Tampering Alarm Detector	Support 8 Local Zones	
	SMS Alarm-Report Push	N/A	YES
	Arming/Disarming via SMS Command	N/A	YES
	Wireless Network Standard	N/A	GPRS
	UIM Card Slot		1
SMA Antenna Interface	1		
Network Management	Network Protocol	SADP (Auto-search IP Address), DHCP (Auto-acquire IP Address) and so on	
External Interface	Network Interface	1 RJ-45; 10M/100M Self-adaptive	
	Keypad Interface	1 RS-485 Half-duplex	
	Port for accumulator	1 , 12VDC/7Ah	
	Printer Interface	1 RS-232 Information Output Interface	
Others	Power Supply	AC 220V	
	Consumption	≤ 60W (Load Power ≤ 40W)	
	Working Temperature	-10°C ~ + 55°C (14°F to 133°F)	
	Working Humidity	10% ~ 90%	
	Installation Mode	Wall-mounting	
	Dimensions(L x W x H)	370 mm × 320 mm × 86 mm	
	Weight	< 3.5kg	