

4

3

2

1

| REVISIONS | | | | |
|-----------|-----|---------------|----------|-------|
| ZONE | REV | DESCRIPTION | DATE | DRAWN |
| | A | 工新字 EG16065 號 | 09/28'16 | NICK |

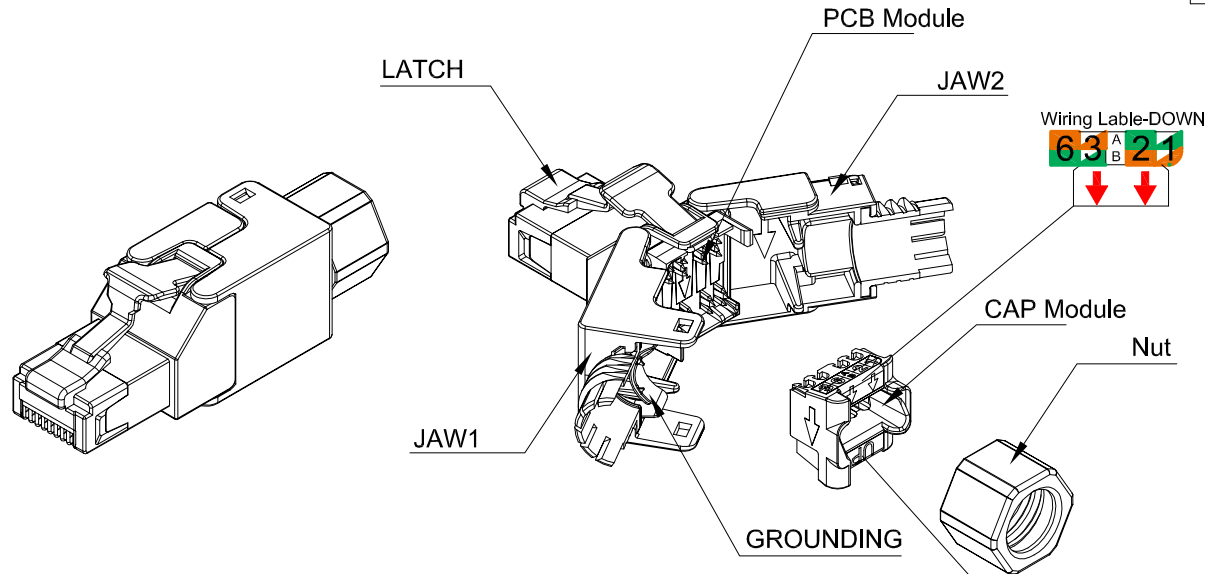

| COMPONENTS | | |
|------------|------------------------------------|------|
| ITEM | PART NAME | Q'TY |
| 1 | PCB Module | 1 |
| 2 | LATCH | 1 |
| 3 | GROUNDING | 1 |
| 4 | JAW1 | 1 |
| 5 | JAW2 | 1 |
| 6 | CAP Module | 1 |
| 7 | Nut | 1 |
| 8 | LL1A01001B-IB6A(Wiring Lable-DOWN) | 1 |
| 9 | LL1A11001B-IB6A(Wiring Lable-UP) | 1 |

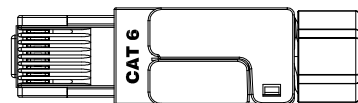
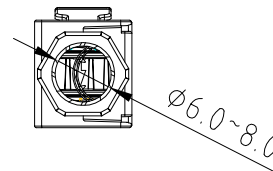
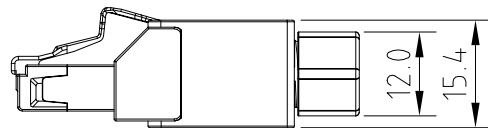
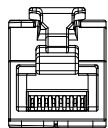
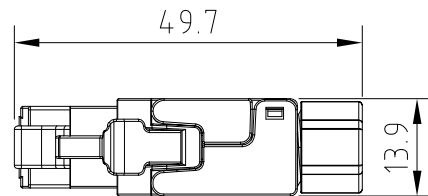

TRANSMISSION PERFORMANCE
Meet all requirements specified in Patch Cord requirement of ANSI/TIA-568-C.2, Category 6

ELECTRICAL

Electrical Insulation Resistance : 500MΩ min. @100V d.c
Dielectric Withstanding Voltage : 1000V D.C or A.C Peak,
Contact to Contact; 1500V D.C or A.C Peak,
Contact to Shield@ 60Hz for 1 Minute.

MECHANICAL

IDC Wire Gauge : 23 ~ 26 AWG

PHYSICAL

Housing : Zinc-alloy fully shielded
Contact pin : Phosphor Bronze Alloy Plated With 50 micro-inch of Gold
IDC : Phosphor Bronze Alloy With 100 micro-inch 100% Sn Alloy

| UNLESS OTHERWISE SPECIFIED: TOLERANCES | | PROJECT ID | | EUROLAN | |
|---|-----------|------------|-------------|-----------|-----------------------------|
| INCH | MM | ANGULAR | 13A-F6-03SL | DATE | TITLE |
| .X ± .016 | .X ± 0.2 | X ± 1° | FILE | Z4276.DWG | CAT 6 FIELD TERMINABLE PLUG |
| .XX ± .008 | .XX ± 0.1 | .X ± .5° | DRAWN | NICK | 03/24'15 |
| .XXX ± .004 | | | CHECK | | |
| | | | APPROVED | | |
| | | | SIZE | A4 | DRAWING NUMBER |
| | | | SCALE | 1:1 | Z4276 |
| | | | UNIT | mm | PART NUMBER |
| | | | SHEET | 1 | OF 1 |
| | | | | | REV |
| | | | | | A |