

4

3

2

1

REVISIONS				
ZONE	REV	DESCRIPTION	DATE	DRAWN

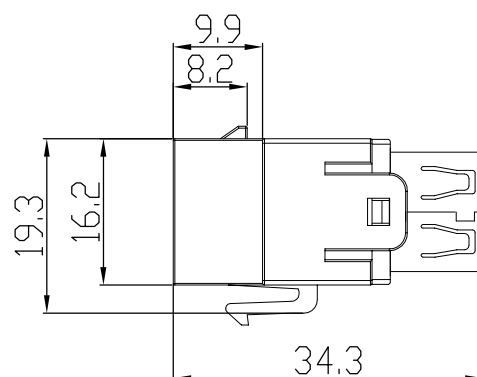
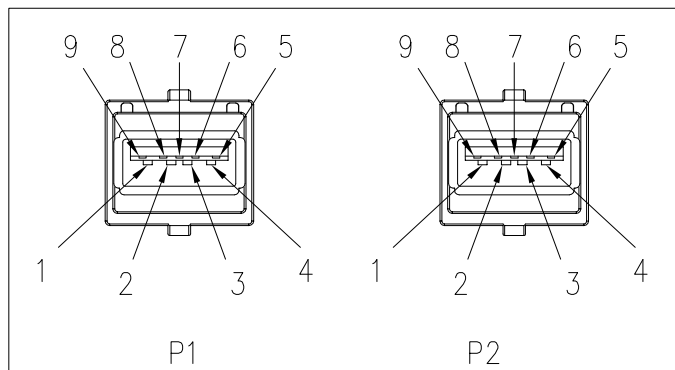
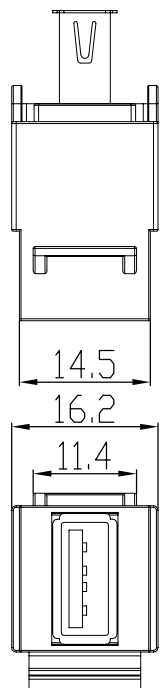

P1		P2	
1	—	1	—
2	—	2	—
3	—	3	—
4	—	4	—
5	—	5	—
6	—	6	—
7	—	7	—
8	—	8	—
9	—	9	—
SHELL	—	SHELL	—

NOTES:

- ELECTRICAL CHARACTERISTICS :
Specification
Contact Resistance: 30m Ohm Max.
Insulation Resistance : 100M Ohm Min. At 500VDC.
Rated Voltage And Current : 1.5A At 100VAC Minimum.
Dielectric Withstanding Voltage :
100V AC (rms) for 1 Minute (Rev. 3.0)
- MECHANICAL CHARACTERISTICS :
Durability (Lift Test) : 1500 Cycles.
Insertion Force : 35 Newton Maximum.
Extraction Force : 10 Newton Minimum.
- HOUSING: ABS 94V0
- PCB: FR-4 Tin PLATING (LEAD FREE)
- CONN: INSULATION: ENGINEERING THERMOPLASTIC BLUE;
CONTACT: PHOS.BRONZE , GOLD OVER NICKEL PLATED;
SHELL: GOLD FLASH PLATING

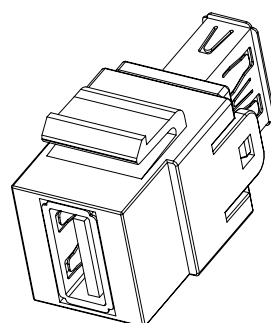
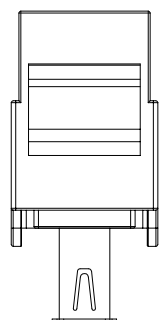
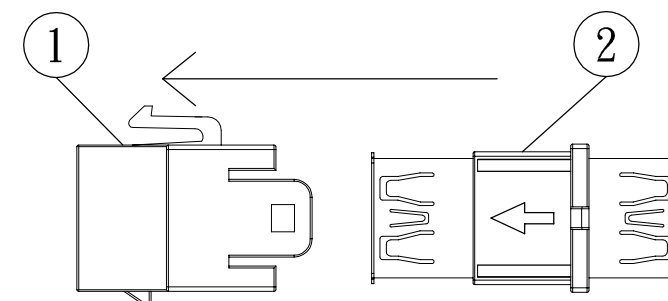

NO.	PART NAME	PART NUMBER	Q'TY
①	USB A 2.0/3.0 HOUSING	LP3054	1
②	USB 3.0 AF/AF ADAPTER	LEFF000068G-ROHS	1

UNLESS OTHERWISE SPECIFIED: TOLERANCES			PROJECT ID 16B-US-03WT		EUROLAN	
INCH	MM	ANGULAR	FILE	DATE	TITLE	
.X ± .016	.X ± 0.2	X ± 1°			Module USB keystone 3.0 Type A	
.XX ± .008	.XX ± 0.1	X ± .5°			SIZE	DRAWING NUMBER
.XXX ± .004					PART NUMBER	REV
MATERIAL	DRAWN				SCALE 2 : 1 UNIT mm SHEET	
SURFACE	CHECK					
FINISH	APPROVED					