

4

3

2

REVISIONS		DATE	DRAWN
ZONE REV	DESCRIPTION		

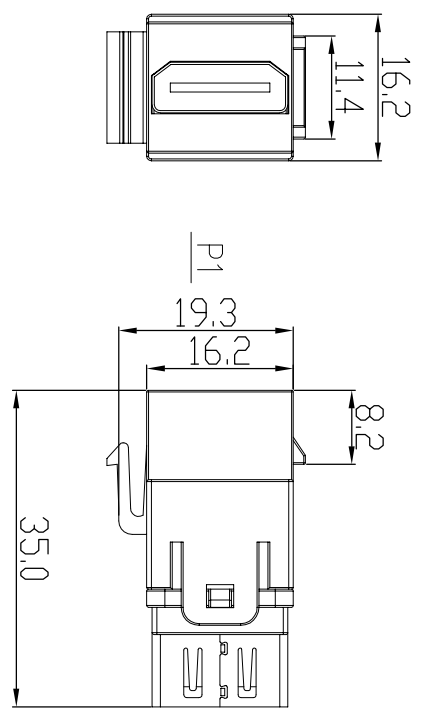
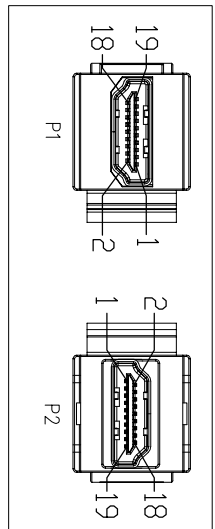
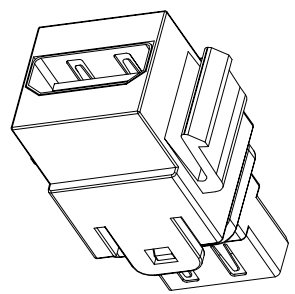
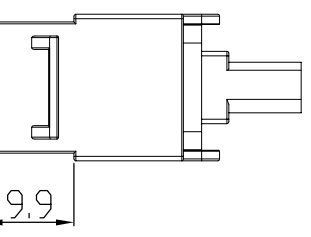

P1	P2
1	1
2	2
3	3
4	4
5	5
6	6
7	7
8	8
9	9
10	10
11	11
12	12
13	13
14	14
15	15
16	16
17	17
18	18
19	19
SHELL	SHELL

- NOTES:
- ELECTRICAL CHARACTERISTICS :
    - 3.1 RATING CURRENT: 0.5A;
    - 3.2 RATING VOLTAGE: 40V;
    - 3.3 CONTACT RESISTANCE: 30m OHMS MAX.
    - 3.4 INSULATION RESISTANCE:

- α:UNMATED: 100M OHMS MIN,AT 500 VDC
- b:MATED: 10M OHMS MIN,AT 150 VDC
- 3.5 DIELECTRIC WITHSTANDING VOLTAGE: 500VAC/1MINUTE
- 3.6 OPERATING TEMPERATURE: -20°C--+85°C
- 3.7 STORAGE TEMPERATURE: -20°C--+65°C
- 3.8 OPERATION /STORAGE HUMIDITY:95% OR LESS.

2. MECHANICAL CHARACTERISTICS :

- 2.1 INSERTION FORCE : 44.1N(MAX)
- 2.2 EXTRACTION FORCE: 9.8N(MIN);39.2N(MAX)
- 2.3 MOTING CYCLE: 5000 CYCLES;
- 2.4 CONTACT PULL OUT FORCE: 5.9N/PIN(MIN)
- 2.5 PLASTIC MATERIAL: ABS 94V-0.

- 3. HOUSING: ABS 94V0
- 4. PCB: FR-4 Tin PLATING (LEAD FREE)
- 5. CONN: HDMI 19P FEMALE.

INSULATION: ENGINEERING THERMOPLASTIC BLACK;  
 CONTACT: COPPER ALLOY, GOLD OVER NICKEL PLATED;  
 SHELL: BRASS, GOLD FLASH PLATING

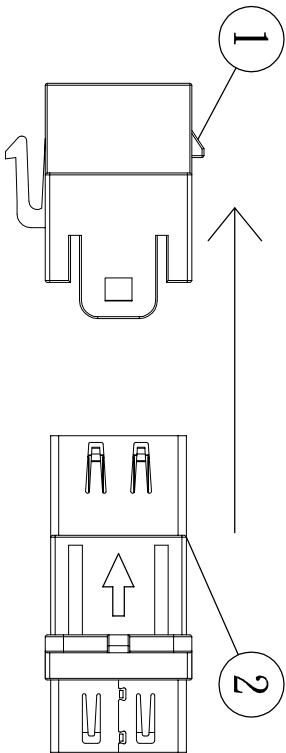
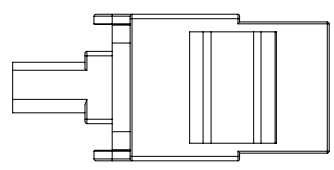

NO.	PART NAME	PART NUMBER	QTY
①	HDMI HOUSING	LP3054B	1
②	HDMI 19PIN F/F	LEFF0000071-ROHS	1

UNLESS OTHERWISE SPECIFIED:

INCH	TOLERANCES	MILL	ANGULAR
±.008	±.01	±.01	±.5°
±.004	±.005	±.01	±.5°

PROJECT ID: 16B-HD-03WT

FILE: DATE:

DRAWN: CHECK: APPROVED:

SCALE: 2 : 1 UNIT: mm SHEET:

**EUTOLPAN**

HDMI keystone module

SIZE: DRAWING NUMBER PART NUMBER REV